

601/81 South Wharf Drive Docklands VIC

2 1 1

Located in one of the Docklands' most highly-regarded buildings in the exclusive Wharf's Entrance precinct, this captivating 2 bedroom, 1 bathroom plus study 'Forge' apartment has been architecturally designed with a focus on luxury, space and spectacular views.

Price : \$600,000-\$660,000

View : <https://www.arel.com.au/sale/vic/inner-city/docklands/residential/apartment/7968628>

The open-plan design is highlighted by full-height glazing, complementing the sublime kitchen flaunting high-end Smeg appliances and illustrious stone surfaces.

Enjoy relaxing or entertaining on your private north-facing balcony, where you can sit and take in the beautiful surrounding views.

Residents of Forge will have exclusive access to an onsite private kitchen/dining room and cinema, and in addition the



Jimmy Lim
03 8686 8388



Dave Tang
03 8686 8388

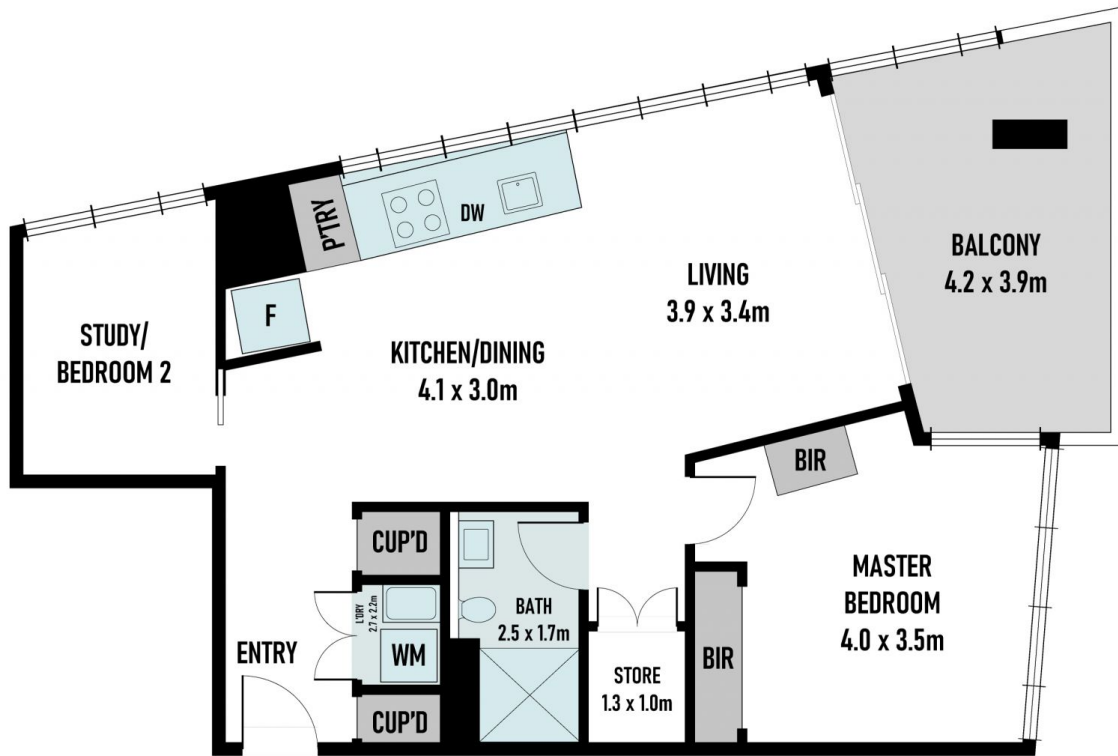

A/REAL

Scale in metres. Indicative only. All information contained herein is obtained from sources we believe to be accurate. We cannot guarantee its accuracy. You should make and rely on your own enquiries.

