

## Two Bedroom Two Bathroom Apartment in Box Hill!

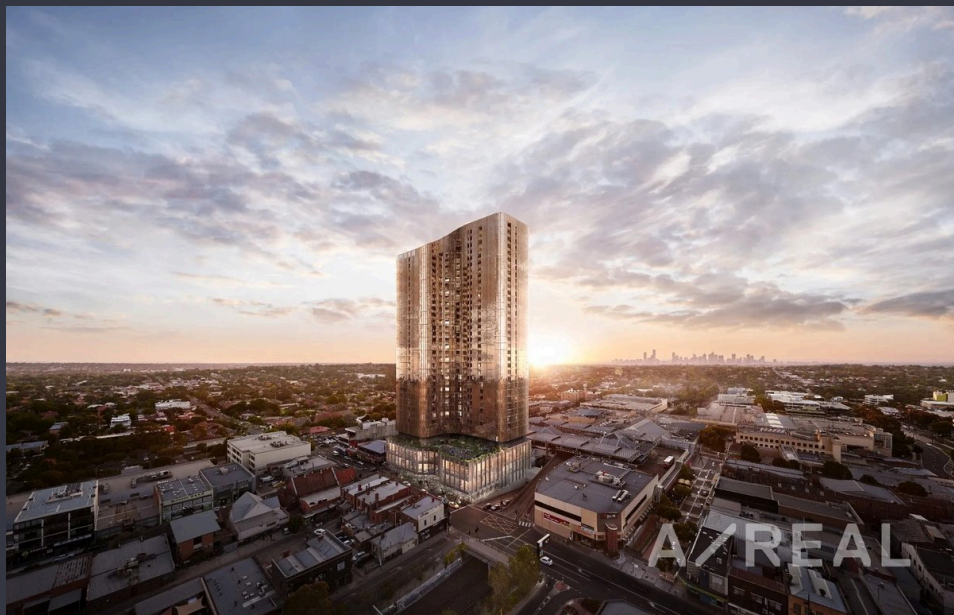

### For Lease

1905/545 Station Street, Box Hill VIC 3128

 2  2

\$770 per Week

## For Lease

1905/545 Station Street, Box Hill VIC 3128



### Two Bedroom Two Bathroom Apartment in Box Hill!

\*\*Scheduling your property inspection is now a breeze! Simply click on the "Book an Inspection" or "Request a Time" button to secure your appointment. You'll instantly receive a confirmation and be kept up-to-date with any alterations or cancellations concerning your scheduled visit. Please be aware, inspections may be subject to cancellation if no bookings are registered. Make your booking today and take the first step in finding your ideal home\*\*

Experience luxury living in this stunning two-bedroom, two-bathroom apartment in the heart of Box Hill, one of Melbourne's fastest growing and most dynamic suburbs. Located within the iconic Sky One building, this residence offers an unbeatable lifestyle with dining, shopping, and entertainment just steps from your door.

Situated adjacent to Box Hill's vibrant transport hub and commercial precinct, you'll enjoy direct access to a three-level retail podium filled with eateries and shops. Box Hill Central and its transport interchange are o...

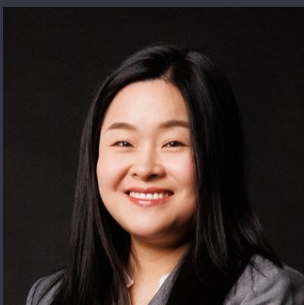

**Rayna Hao**

Senior Relationship Manager

03 9818 8991

rayna.hao@areal.com.au

A/REAL



A/REAL



A/REAL



## INSPECTION & APPLICATION PROCESS



VIEW LISTING ONLINE



GET IN TOUCH



ATTEND AN INSPECTION



APPLY ONLINE

Click the “[Register](#)” or “[Book with Inspect Real Estate](#)” button and enter your preferred contact details so that we can keep you up to date with any changes or cancellations to your booking.

If the advertised time does not suit: click “[Get in Touch](#)” or “[Email](#)” to submit your interest in the property. You will then be kept up to date about any future inspections.

[Attend an inspection](#) with one of our Leasing Specialists.

After your inspection, you will receive a link with instructions on how to [apply online via 2Apply](#).

Visit [www.2apply.com.au](http://www.2apply.com.au)

## BOX HILL

Suite 3.4, Level 3, 990 Whitehorse Road, Box Hill. Victoria 3128 | 8686 8388

## HAWTHORN EAST

33 Camberwell Road, Hawthorn. Victoria 3123 | 9818 8991

## MELBOURNE CBD

Level 7, 99 Queen Street, Melbourne. VIC 3000 | 9818 8991

## NORTH

Suites 4 & 5 High Street, Lalor. VIC 3075 | 03 9436 0888

## POINT COOK

Entrance C4, Level 1, 2 Main Street, Point Cook. VIC 3030 | 8686 8338

## SOUTH MORANG

29 Gorge Road, South Morang. VIC 3752 | 8804 5888

[info@areal.com.au](mailto:info@areal.com.au)