

A/REAL

Contemporary Living at its Best



For Sale

42 Ellsworth Crescent, Camberwell VIC 3124

 4  2

\$1,918,888

For Sale

42 Ellsworth Crescent, Camberwell VIC 3124

 4  2

Contemporary Living at its Best

The impressive ultra-modern exterior of this four-bedroom, three-bathroom family home is just one of the many reasons you will love living at this address! You can stroll to Lynden Park, Wattle Park Golf Course and the tram and everything you need is nearby.

The sophisticated interior has a timeless neutral colour scheme with a stunning gourmet kitchen in the heart of the open-plan layout. It has a stone top breakfast bar for gathering for quick meals. You'll love the handleless cabinets and the quality stainless-steel Miele appliances. The living area extends out from the dining and the lounge through sliding doors to a paved courtyard and backyard - perfect for entertaining guests. There's also a powder room and laundry on the main level for convenience.

The master bedroom on the ground floor is a relaxing sanctuary with a large walk-in wardrobe, an ensuite with twin vanity, a huge, mirrored cabinet, a shower and a free-standing bath, so you can indulge in a soak in the tub.

On...





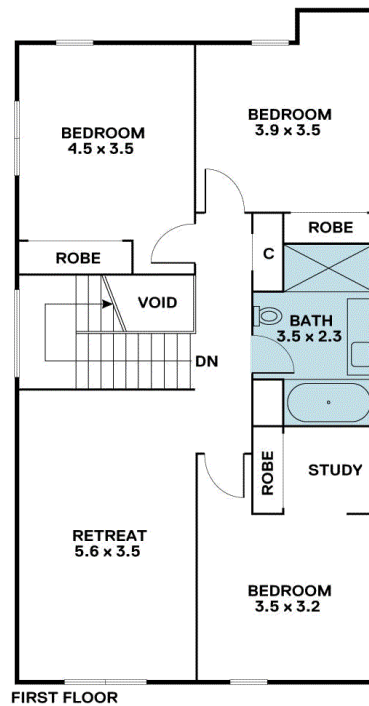
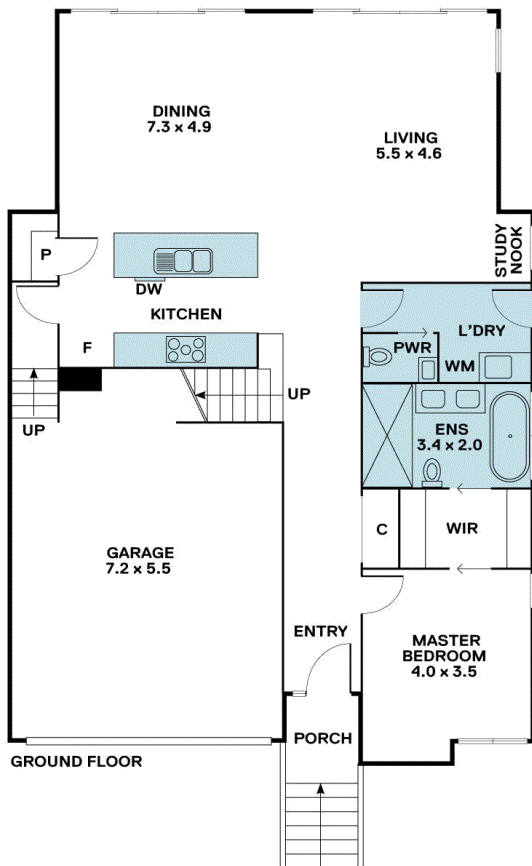

BOX HILL

Suite 3.4, Level 3, 990 Whitehorse Road, Box Hill. Victoria 3128 | 8686 8388

HAWTHORN EAST

33 Camberwell Road, Hawthorn. Victoria 3123 | 9818 8991

MELBOURNE CBD

Level 7, 99 Queen Street, Melbourne. VIC 3000 | 9818 8991

NORTH

Suites 4 & 5 High Street, Lalor. VIC 3075 | 03 9436 0888

POINT COOK

Entrance C4, Level 1, 2 Main Street, Point Cook. VIC 3030 | 8686 8338

SOUTH MORANG

29 Gorge Road, South Morang. VIC 3752 | 8804 5888

info@areal.com.au