

Great Central Mill Park Location



For Sale

212/24 Oleander Drive, Mill Park VIC 3082

 2  2

\$365,000

For Sale

212/24 Oleander Drive, Mill Park VIC 3082



Great Central Mill Park Location

Perfectly positioned close to local cafes, shopping and transport options in the heart of South Morang's Centre this light-filled two-bedroom apartment offers an opportunity to first-home buyers, investors and downsizers alike! The impressive layout allows for both bedrooms and the living area to have direct access to the balcony through sliding doors – so you can walk out and take in the fresh air anytime!

This beautifully designed home has a modern open-plan layout, with stone bench tops, a European laundry, and a split air-conditioned living area.

You'll love cooking up a storm in the kitchen with a breakfast bar where you can be seated for a quick meal or a coffee. Prepping will be easy with lots of cupboard and bench space with quality stainless steel appliances and gas cooking.

There's plenty of storage throughout the unit with built-in vanity cabinets and built-in robes. The main bedroom has two built-in robes and a private ensuite and the apartment has comfortable carpets a...



A/REAL



A/REAL



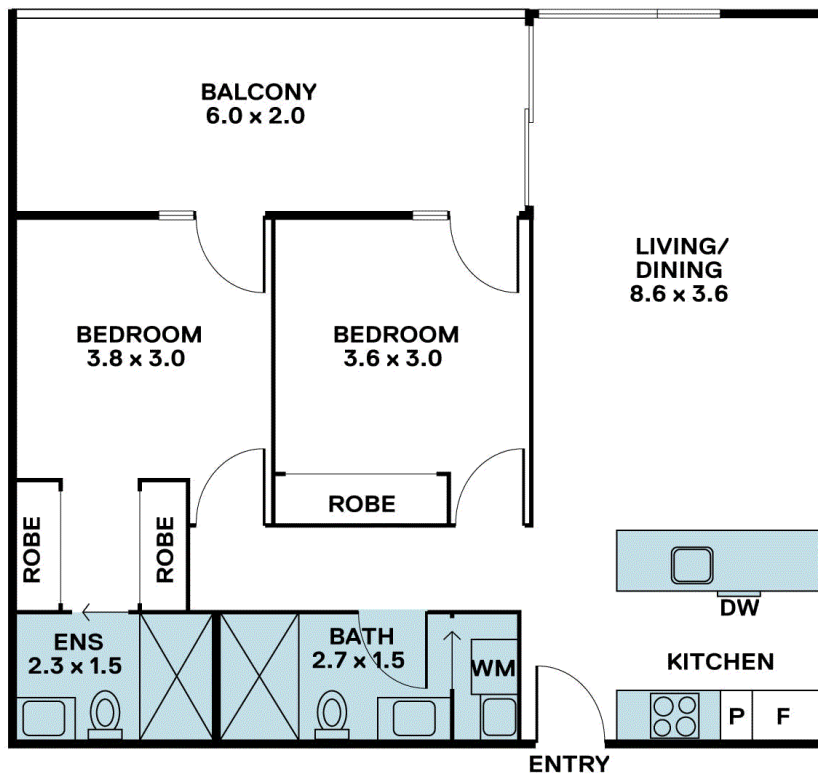

BOX HILL

Suite 3.4, Level 3, 990 Whitehorse Road, Box Hill. Victoria 3128 | 8686 8388

HAWTHORN EAST

33 Camberwell Road, Hawthorn. Victoria 3123 | 9818 8991

MELBOURNE CBD

Level 7, 99 Queen Street, Melbourne. VIC 3000 | 9818 8991

NORTH

Suites 4 & 5 High Street, Lalor. VIC 3075 | 03 9436 0888

POINT COOK

Entrance C4, Level 1, 2 Main Street, Point Cook. VIC 3030 | 8686 8338

SOUTH MORANG

29 Gorge Road, South Morang. VIC 3752 | 8804 5888

info@areal.com.au