

Spacious Two Bedroom home in Family Friendly Estate



For Sale

217/16 Lomandra Drive, Clayton South VIC 3169

 2  1

\$410,000

For Sale

217/16 Lomandra Drive, Clayton South VIC 3169

 2  1

Spacious Two Bedroom home in Family Friendly Estate

This two-bedroom contemporary apartment ticks all the boxes in a great location positioned just metres from the train station, shops, and bus stop for an easy commute. This modern home is in near-new condition with quality fixtures and fittings throughout and includes a bathroom with floor-to-ceiling tiles, a stone benchtop kitchen and lots of storage space.

The spacious light-filled living area is separate from the bedrooms on either side of the bathroom providing peace and privacy for residents. Both bedrooms have built-in robes and comfortable carpets, and one has sliding door access to the balcony. Plus, the modern and fully tiled bathroom has a large, mirrored vanity so you'll have plenty of room to get ready.

The main living area is complemented by two balconies, one with views over rooftops and one adjoining the main bedroom and kitchen. You'll be able to enjoy these as private spaces to relax or as an area to entertain guests.

You'll love the smart layout and well-appointed...



Andy Yuan

Senior Sales Executive, Licensed Estate Agent, Auctioneer

0406 217 388

03 8686 8388

andy.yuan@areal.com.au





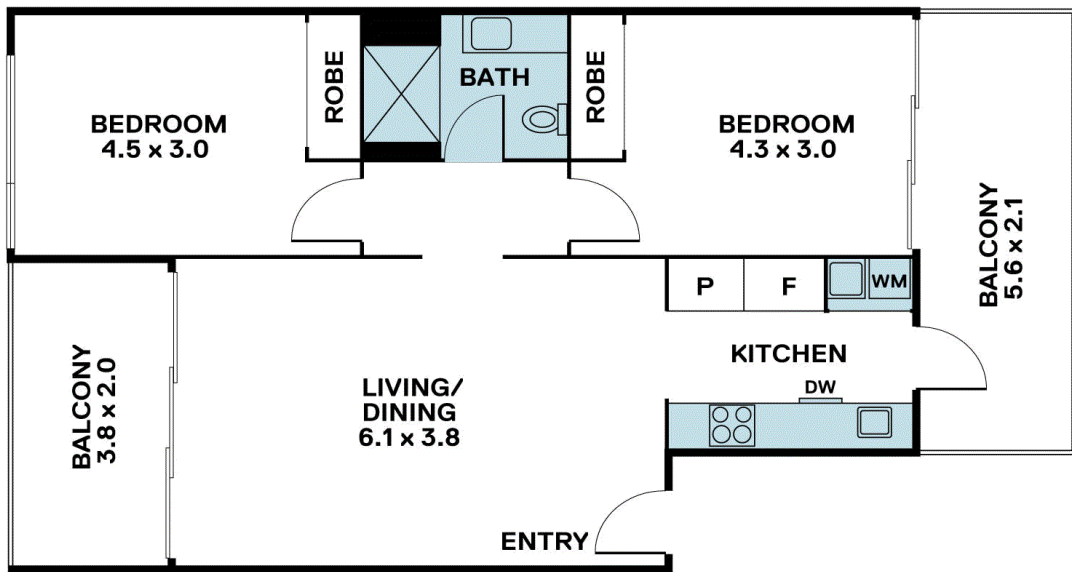

BOX HILL

Suite 3.4, Level 3, 990 Whitehorse Road, Box Hill. Victoria 3128 | 8686 8388

HAWTHORN EAST

33 Camberwell Road, Hawthorn. Victoria 3123 | 9818 8991

MELBOURNE CBD

Level 7, 99 Queen Street, Melbourne. VIC 3000 | 9818 8991

NORTH

Suites 4 & 5 High Street, Lalor. VIC 3075 | 03 9436 0888

POINT COOK

Entrance C4, Level 1, 2 Main Street, Point Cook. VIC 3030 | 8686 8338

SOUTH MORANG

29 Gorge Road, South Morang. VIC 3752 | 8804 5888

info@areal.com.au