

Superior Suburban Living with Impeccable Presentation on over 600 sqm of Land



For Sale

136 Grevillea Street, Craigieburn VIC 3064

 4  2  603sqm

\$762,000

For Sale

136 Grevillea Street, Craigieburn VIC 3064



4



2



603sqm

Superior Suburban Living with Impeccable Presentation on over 600 sqm of Land

Sporting a pristine contemporary style and neatly positioned in sought-after Craigieburn, this 4-bedroom, 2-storey home features an elegant design that maximises its space to its full potential.

Daily living will be spread throughout, with a front lounge providing a warm welcome, while the open-plan kitchen, dining and living room forms the heart of the home with real room to move and relax. Upstairs, the landing offers great potential as an additional living space or as a quiet study.

A sliding glass door offers a seamless transition to the fully-fenced yard, which provides the ultimate spot for playing with family and entertaining guests.

Modern finishes are a theme throughout and the kitchen is no exception, coming well-equipped with stainless-steel appliances, plentiful benchtop space and flawless cabinetry.

Each of the bedrooms are generously-sized with built-in robes, while the master maintains a walk-in wardrobe and private ensuite.

Disclaimer: We have in preparing the co...



Andy Yuan

Senior Sales Executive, Licensed Estate Agent, Auctioneer

0406 217 388

03 8686 8388

andy.yuan@areal.com.au

A/REAL





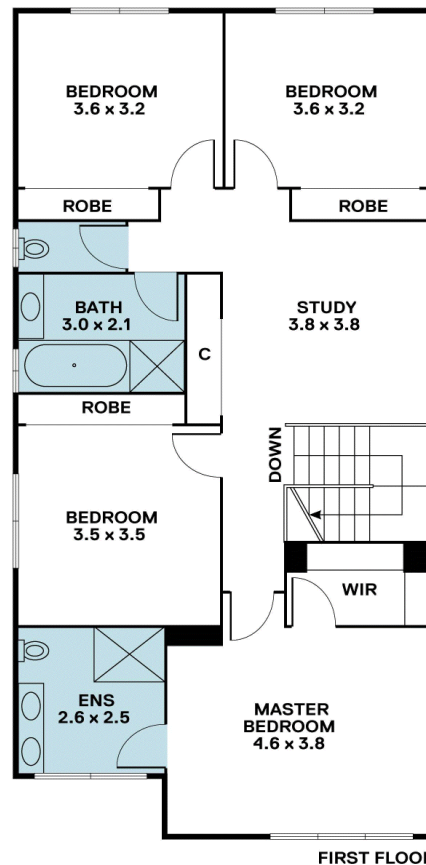
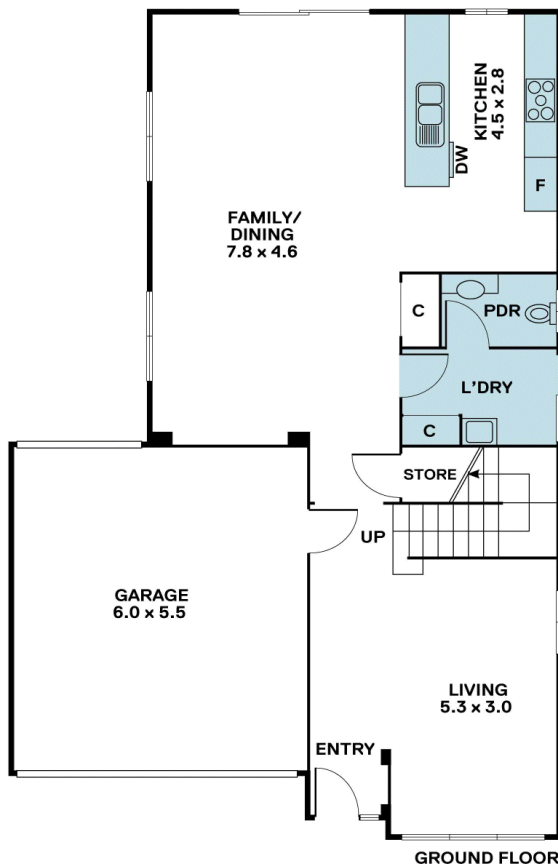

BOX HILL

Suite 3.4, Level 3, 990 Whitehorse Road, Box Hill. Victoria 3128 | 8686 8388

HAWTHORN EAST

33 Camberwell Road, Hawthorn. Victoria 3123 | 9818 8991

MELBOURNE CBD

Level 7, 99 Queen Street, Melbourne. VIC 3000 | 9818 8991

NORTH

Suites 4 & 5 High Street, Lalor. VIC 3075 | 03 9436 0888

POINT COOK

Entrance C4, Level 1, 2 Main Street, Point Cook. VIC 3030 | 8686 8338

SOUTH MORANG

29 Gorge Road, South Morang. VIC 3752 | 8804 5888

info@areal.com.au