

A stylish apartment close to  
shops, cafes and parks



For Sale

402/12 Trenerry Crescent, Abbotsford VIC 3067



\$415,000

## For Sale

402/12 Trenerry Crescent, Abbotsford VIC 3067



### A stylish apartment close to shops, cafes and parks

Move in and make yourself at home or rent out and reap fantastic returns, the choice is yours when it comes to this modern and easy-care unit. The highly sought-after Abbotsford location means you're just a gentle stroll from bustling shops, parks and public transport links plus you're less than 20 minutes (approx.) from the heart of the Melbourne CBD.

Step inside where your light-filled, comfortable and functional floorplan awaits. There is one bedroom, with a built-in robe, and one bathroom with in-unit laundry facilities for added convenience.

Everyday life will revolve around the open-plan kitchen, dining and living room with crisp white walls, on-trend flooring and contemporary finishes throughout. Stainless steel appliances in the kitchen are sure to impress any eager cook plus there's a tiled backsplash, plenty of bench space and a good-size pantry for storage.

That enviable indoor-outdoor lifestyle could be all yours with a seamless connection between the living room and ...





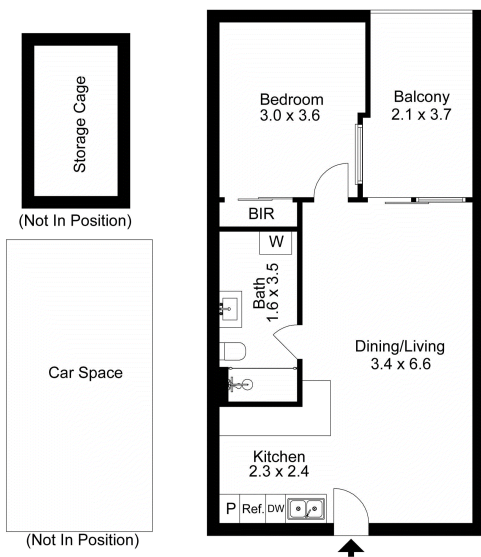

## BOX HILL

Suite 3.4, Level 3, 990 Whitehorse Road, Box Hill. Victoria 3128 | 8686 8388

## HAWTHORN EAST

33 Camberwell Road, Hawthorn. Victoria 3123 | 9818 8991

## MELBOURNE CBD

Level 7, 99 Queen Street, Melbourne. VIC 3000 | 9818 8991

## NORTH

Suites 4 & 5 High Street, Lalor. VIC 3075 | 03 9436 0888

## POINT COOK

Entrance C4, Level 1, 2 Main Street, Point Cook. VIC 3030 | 8686 8338

## SOUTH MORANG

29 Gorge Road, South Morang. VIC 3752 | 8804 5888

[info@areal.com.au](mailto:info@areal.com.au)