

Side by side townhouse with lift!
Close to Deakin Uni & Box Hill
Central



For Sale

2/21 Sixth Avenue, Burwood VIC 3125



4



4



362sqm

\$1,880,000

For Sale

2/21 Sixth Avenue, Burwood VIC 3125



4



4



362sqm

Side by side townhouse with lift! Close to Deakin Uni & Box Hill Central

Burwood offers locals the reassurance of being a safe and vibrant suburb to live, located only 30 minutes to Melbourne's CBD. Burwood is a family-friendly suburb that is highly desirable with schools, shopping and amenities at your doorstep including Deakin University, Burwood One with 24 hours Kmart, the newest shopping addition being Burwood Brickworks Shopping Centre, etc.

Project Features: Contemporary high-end three storeys townhouses, 4 bedrooms with ensuite units & underground double garage. Comfort living area includes theatre, wine cellar, lift, two spacious living/family areas, modern kitchen comes with kitchen island and pantry. The best location, close to a couple of famous colleges & schools, the busy commercial street is just around the corner from the doorway.

Luxury inclusions: Miele/Smeg Kitchen Appliances Unit 1 / Bosch Kitchen Appliances Unit 2, Premium Kitchen Cabinets, 40mm Bench Top & 100mm island bench by using YDL Marble Premium plus range. Floor to ceiling...





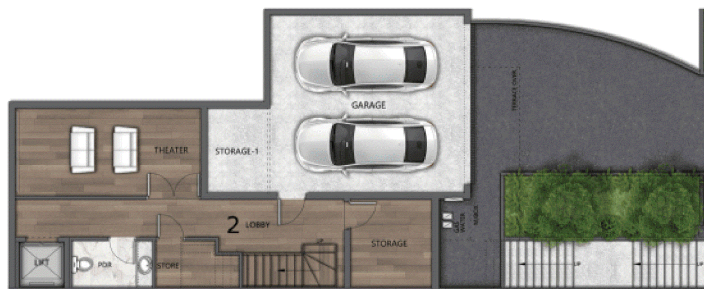

UNIT 2	2 🛏	4 🚿	4.5 🏠	2 🚗
BASEMENT	105.98 m ²	TERRACE	8.53 m ²	
GROUND FLOOR	171.76 m ²	BALCONY	10.79 m ²	
FIRST FLOOR	124.96 m ²	PRIVATE OPEN SPACE	79.32 m ²	

21 SIXTH AVENUE
- BURWOOD VIC 3125 -

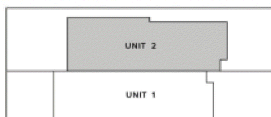

DISCLAIMER: This document has been produced by the developer for advertising and general information only. The developer and its project team do not guarantee, warrant or represent that the information contained within this document is correct. Any interested parties should undertake their own enquiries as to the accuracy of this document. The developer excludes unequivocally all implied or explicit terms, conditions and warranties arising out of this document and excludes all liability for loss and are subject to change without notice and should be verified by the purchaser on or prior to exchange. The information contained herein is

BOX HILL

Suite 3.4, Level 3, 990 Whitehorse Road, Box Hill. Victoria 3128 | 8686 8388

HAWTHORN EAST

33 Camberwell Road, Hawthorn. Victoria 3123 | 9818 8991

MELBOURNE CBD

Level 7, 99 Queen Street, Melbourne. VIC 3000 | 9818 8991

NORTH

Suites 4 & 5 High Street, Lalor. VIC 3075 | 03 9436 0888

POINT COOK

Entrance C4, Level 1, 2 Main Street, Point Cook. VIC 3030 | 8686 8338

SOUTH MORANG

29 Gorge Road, South Morang. VIC 3752 | 8804 5888

info@areal.com.au