

A/REAL

IT DOESNT GET ANY MORE
ATTRACTIVE THAN ATRIA!

Inspection: Saturday 11th July
11:45am - 12:00pm



For Lease

409/311 Burwood Road, Hawthorn VIC 3122

 2  2

\$530 per Week

For Lease

409/311 Burwood Road, Hawthorn VIC 3122



IT DOESNT GET ANY MORE ATTRACTIVE THAN ATRIA! Inspection: Saturday 11th July 11:45am - 12:00pm

Inspection: Saturday 11th July 11:45am - 12:00pm

To APPLY, you must INSPECT the property FIRST. Its easy, simply click on EMAIL AGENT, enter your details and receive instant details of the next inspection time.

Please register to inspect this property. When inspection times are scheduled/changed or the property is no longer available, only those registered will be advised.

Enter from Burwood Road Entrance.

Looking to establish yourself in Hawthorn? Be the first to live in these brand new luxury apartments that really do tick all the boxes!

Featuring premium fittings and fixtures throughout, stylish mixtures of carpet and floorboards, great sized living spaces with plenty of natural light, bedrooms with BIRs and a study desk, fully equipped kitchens with stone bench tops and stainless steel European appliances, Sparkling modern bathrooms, European laundry and floor to ceiling glass doors leading to ample balcony boasting spectacular views.

Building facilities include secured ent...







ATRIA

APARTMENTS HAWTHORN
www.atria.com.au

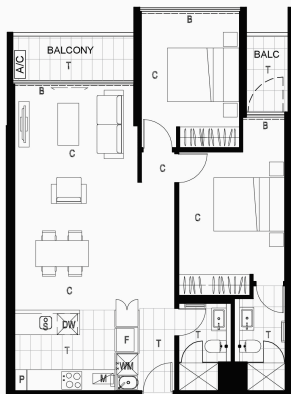

Level	L04
Apartment Number	B4.09
No. of Bedrooms	2
No. of Bathrooms	2
Estimated Area	
Floor Area	77 m ²
Balcony Area	8 m ²
Total Area	85 m ²

Car Space
1

Developed By:



CAYDON
T = 613 9416 3400
F = 613 9416 3404
34 STANLEY STREET
COLLINGWOOD VIC 3066
www.caydon.com.au

Key Plan



Dimensions and areas are approximate and are subject to change. Internal measurements are taken from centreline of party walls and external face of the outside wall. Prospective purchasers must rely on their own enquiries and should refer to plans, terms and conditions in the contract of sale. Loose furniture, white goods and planters represented are not included.

F = Fridge
P = Pantry
S = Sink
DW = Dishwasher
M = Microwave
L = Linen
WM = Washing Machine
ST = Study
T = Tile
A/C = Airconditioner
T = Tile
C = Carpet
TF = Timber Flooring
HW = Highlight Window



WARDROBE STORAGE SYSTEM



BOX HILL

Suite 3.4, Level 3, 990 Whitehorse Road, Box Hill. Victoria 3128 | 8686 8388

HAWTHORN EAST

33 Camberwell Road, Hawthorn. Victoria 3123 | 9818 8991

MELBOURNE CBD

Level 7, 99 Queen Street, Melbourne. VIC 3000 | 9818 8991

NORTH

Suites 4 & 5 High Street, Lalor. VIC 3075 | 03 9436 0888

POINT COOK

Entrance C4, Level 1, 2 Main Street, Point Cook. VIC 3030 | 8686 8338

SOUTH MORANG

29 Gorge Road, South Morang. VIC 3752 | 8804 5888

info@areal.com.au