

## Elite Level Luxury With Brand New Appeal in Box Hill School Zone



### For Sale

17/325 Station Street, Box Hill South VIC 3128

 4  3

\$1,280,000-\$1,400,000

## For Sale

17/325 Station Street, Box Hill South VIC 3128

 4  3

### Elite Level Luxury With Brand New Appeal in Box Hill School Zone

Redefining the concepts of luxury, this brand new architecturally designed residence sets the bar high for contemporary excellence, exuding class and sophistication at every turn.

Be immediately captivated by the bespoke finishes paired with stunning timber floors and soft neutral tones that enhance the light-filled open-plan living/dining area, including a state-of-the-art kitchen, lavishly appointed with premium appliances, stone surfaces and island bench.

Appreciate the flexibility of ground and upper-level main bedrooms, each fitted with a striking fully-tiled ensuite, accompanied by 2 further robed bedrooms, sleek family bathroom and teenage retreat. Promoting unrivalled quality, this remarkable home is complete with heating/AC, entertaining deck and double garage.

Equally alluring is its prime lifestyle location within the Box Hill High zone, surrounded by excellent schools, shopping, and open green spaces. Enjoy being able to walk to Roberts McCubbin Primary School, Box Hil...



### Andy Yuan

Senior Sales Executive, Licensed Estate Agent, Auctioneer

0406 217 388

03 8686 8388

[andy.yuan@areal.com.au](mailto:andy.yuan@areal.com.au)



### Dave Tang

Sales Executive

0432 523 853

03 8686 8388

[dave.tang@areal.com.au](mailto:dave.tang@areal.com.au)

A/REAL



A/REAL



A/REAL

A/REAL





A/REAL

Total Area: 184m<sup>2</sup>  
 Internal Area: 150m<sup>2</sup>  
 Garage: 34m<sup>2</sup>  
 (Approx.)



Ground Floor

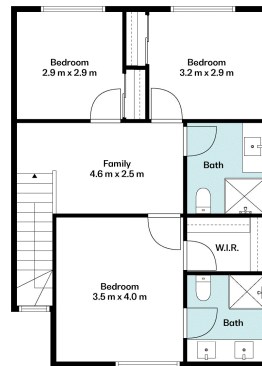

First Floor

## BOX HILL

Suite 3.4, Level 3, 990 Whitehorse Road, Box Hill. Victoria 3128 | 8686 8388

## HAWTHORN EAST

33 Camberwell Road, Hawthorn. Victoria 3123 | 9818 8991

## MELBOURNE CBD

Level 7, 99 Queen Street, Melbourne. VIC 3000 | 9818 8991

## NORTH

Suites 4 & 5 High Street, Lalor. VIC 3075 | 03 9436 0888

## POINT COOK

Entrance C4, Level 1, 2 Main Street, Point Cook. VIC 3030 | 8686 8338

## SOUTH MORANG

29 Gorge Road, South Morang. VIC 3752 | 8804 5888

[info@areal.com.au](mailto:info@areal.com.au)

[areal.com.au](http://areal.com.au)