

Unmissable Investment Opportunity: 12% Rental Yield in the heart of Melbourne



For Sale

1234/43 Therry Street, Melbourne VIC 3000

 1  1

Contact Agent

For Sale

1234/43 Therry Street, Melbourne VIC 3000



Unmissable Investment Opportunity: 12% Rental Yield in the heart of Melbourne

Conveniently placed within the Mercure Hotel complex towards the Northern end of the CBD, this studio apartment is an alluring opportunity for first home buyers or students looking to gain a foothold in the Melbourne market, or astute investors wanting to add to their property portfolio.

Filled with natural light and well-maintained throughout, it comprises an open-plan environment, immaculate kitchen, bathroom and split system heating/AC.

Advantaged by a prized location, a heartbeat to Queen Victoria Market, Melbourne Central, Emporium and in the prestigious University High zone.

Disclaimer: We have in preparing the content used our best endeavours to ensure that the information contained is true and accurate, however accept no responsibility and disclaim all liability in respect to any errors, omissions, inaccuracies or misstatements in this document. Prospective purchasers should make their own enquiries to verify the information contained in this document. Prospective purchaser...

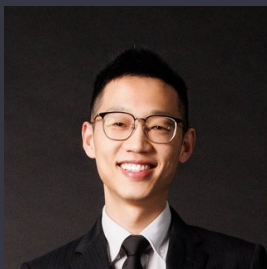

Eddie Zhu

Managing Director - AReal Property Melbourne, Licensed Estate Agent

0452 585 423

03 9818 8991

eddie.zhu@areal.com.au

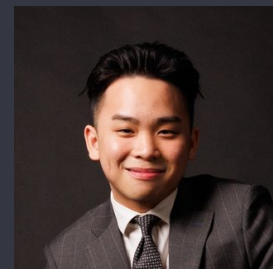

Aaron Tan

Sales Executive

0421 247 332

03 8686 8388

aaron.tan@areal.com.au

A/REAL



A/REAL





Living Area: 28m²
(approx.)

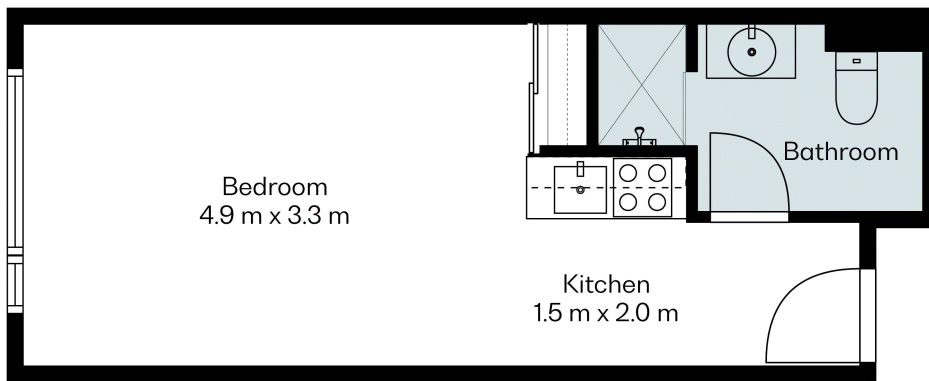



BOX HILL

Suite 3.4, Level 3, 990 Whitehorse Road, Box Hill. Victoria 3128 | 8686 8388

HAWTHORN EAST

33 Camberwell Road, Hawthorn. Victoria 3123 | 9818 8991

MELBOURNE CBD

Level 7, 99 Queen Street, Melbourne. VIC 3000 | 9818 8991

NORTH

Suites 4 & 5 High Street, Lalor. VIC 3075 | 03 9436 0888

POINT COOK

Entrance C4, Level 1, 2 Main Street, Point Cook. VIC 3030 | 8686 8338

SOUTH MORANG

29 Gorge Road, South Morang. VIC 3752 | 8804 5888

info@areal.com.au

areal.com.au