

Modern & Spacious Apartment in the Heart of Clayton South

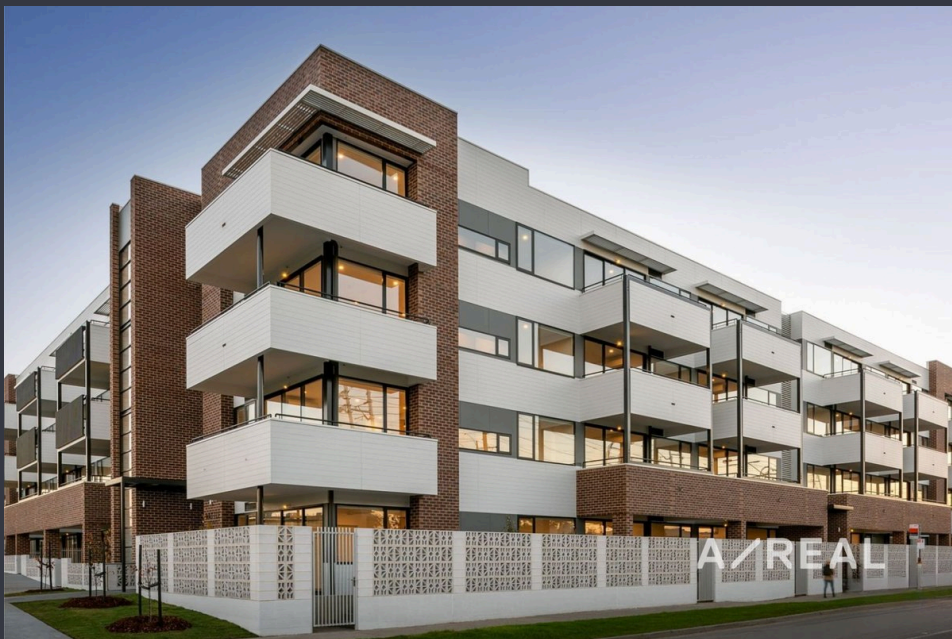

For Lease

308/16 Lomandra Drive, Clayton South VIC 3169

 1  1

\$540 per Week

For Lease

308/16 Lomandra Drive, Clayton South VIC 3169



Modern & Spacious Apartment in the Heart of Clayton South

Scheduling your property inspection is now a breeze! Simply click on the "Book an Inspection" or "Request a Time" button to secure your appointment. You'll instantly receive a confirmation and be kept up-to-date with any alterations or cancellations concerning your scheduled visit. Please be aware, inspections may be subject to cancellation if no bookings are registered. Make your booking today and take the first step in finding your ideal home

This stunning, modern apartment is designed for comfort, style, and convenience, making it the perfect choice for professionals, small families, or students seeking a vibrant and connected lifestyle. Nestled in the thriving suburb of Clayton South, this property offers an unbeatable location with easy access to all the amenities you need for a fulfilling life. The spacious 1 bedroom, 1-bathroom layout features a bright and airy open-plan living area that seamlessly connects to a sleek, contemporary kitchen equipped with high-quality stainl...

A/REAL





BOX HILL

Suite 3.4, Level 3, 990 Whitehorse Road, Box Hill. Victoria 3128 | 8686 8388

HAWTHORN EAST

33 Camberwell Road, Hawthorn. Victoria 3123 | 9818 8991

MELBOURNE CBD

Level 7, 99 Queen Street, Melbourne. VIC 3000 | 9818 8991

NORTH

Suites 4 & 5 High Street, Lalor. VIC 3075 | 03 9436 0888

POINT COOK

Entrance C4, Level 1, 2 Main Street, Point Cook. VIC 3030 | 8686 8338

SOUTH MORANG

29 Gorge Road, South Morang. VIC 3752 | 8804 5888

info@areal.com.au