

## Light-Filled Studio in Prime South Yarra Location



For Lease

315/30-34 Bray Street, South Yarra VIC 3141



\$425 per Week

## For Lease

315/30-34 Bray Street, South Yarra VIC 3141



### Light-Filled Studio in Prime South Yarra Location

\*\*Scheduling your property inspection is now a breeze! Simply click on the "Book an Inspection" or "Request a Time" button to secure your appointment. You'll instantly receive a confirmation and be kept up-to-date with any alterations or cancellations concerning your scheduled visit. Please be aware, inspections may be subject to cancellation if no bookings are registered. Make your booking today and take the first step in finding your ideal home\*\*

Step into style, comfort and convenience with this superbly designed studio apartment, perfectly positioned just 78 metres from Chapel Street's boutiques and cafes, 270 metres from the iconic Jam Factory and only a few minutes' walk to South Yarra Station.

The cleverly designed layout includes a queen-size foldaway bed that transforms your living space in seconds, creating extra room for entertaining. The galley-style kitchen is fitted with quality stainless steel appliances, a gas cooktop, dish drawer, multi-function oven, pantry, stone ...

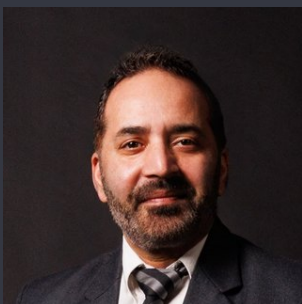

### Ranjit Singh

Senior Relationship Manager

03 9818 8991

ranjit.singh@areal.com.au

A/REAL



A/REAL



## INSPECTION & APPLICATION PROCESS



VIEW LISTING ONLINE



GET IN TOUCH



ATTEND AN INSPECTION



APPLY ONLINE

Click the "Register" or "Book with Inspect Real Estate" button and enter your preferred contact details so that we can keep you up to date with any changes or cancellations to your booking.

If the advertised time does not suit: click "Get in Touch" or "Email" to submit your interest in the property. You will then be kept up to date about any future inspections.

Attend an inspection with one of our Leasing Specialists.

After your inspection, you will receive a link with instructions on how to apply online via 2Apply.

Visit [www.2apply.com.au](http://www.2apply.com.au)

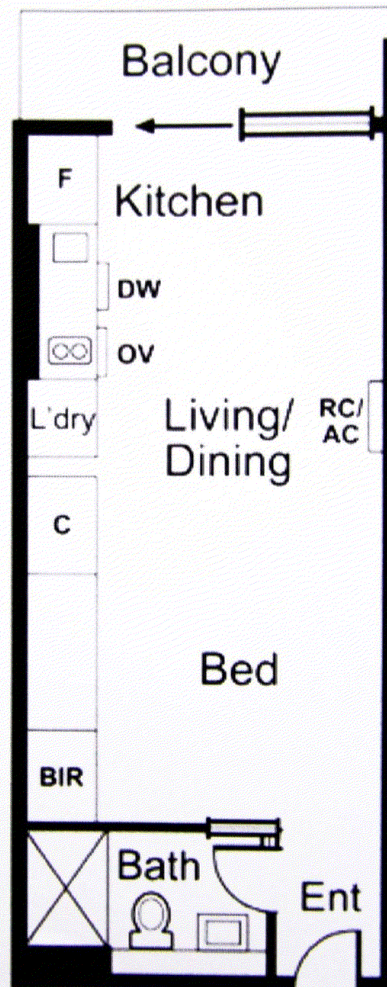

## BOX HILL

Suite 3.4, Level 3, 990 Whitehorse Road, Box Hill. Victoria 3128 | 8686 8388

## HAWTHORN EAST

33 Camberwell Road, Hawthorn. Victoria 3123 | 9818 8991

## MELBOURNE CBD

Level 7, 99 Queen Street, Melbourne. VIC 3000 | 9818 8991

## NORTH

Suites 4 & 5 High Street, Lalor. VIC 3075 | 03 9436 0888

## POINT COOK

Entrance C4, Level 1, 2 Main Street, Point Cook. VIC 3030 | 8686 8338

## SOUTH MORANG

29 Gorge Road, South Morang. VIC 3752 | 8804 5888

[info@areal.com.au](mailto:info@areal.com.au)