

Elevated Docklands Living with Skyline Views and Parking



For Sale

803/387 Docklands Drive, Docklands VIC 3008

 2  1

\$495,000 - \$540,000

For Sale

803/387 Docklands Drive, Docklands VIC 3008

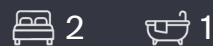

Elevated Docklands Living with Skyline Views and Parking

Elevated within the architecturally distinctive Elm & Stone at NewQuay, this two-bedroom apartment pairs loft-inspired proportions with one of Docklands' most connected addresses. Raw concrete ceilings, black track lighting and engineered oak floors give the open-plan living and dining zone an appealing warehouse character, while floor-to-ceiling glass draws natural light into the interior throughout the day.

The lounge opens to a sizeable balcony with its own built-in planter, framing a sweeping outlook across the Docklands skyline and waterfront precinct. The adjoining kitchen is finished with stone benchtops, tiled splashback, overhead cabinetry and quality European appliances, offering a sleek setting for both home cooking and entertaining.

Both well-proportioned bedrooms are carpeted for comfort and fitted with mirrored built-in robes. A stylish bathroom features a sculptural basin, black tapware, a mirrored cabinet and a rainfall shower. Split-system heating and cooling, a vid...



Andy Yuan

Senior Sales Executive, Licensed Estate Agent, Auctioneer

0406 217 388

03 8686 8388

andy.yuan@areal.com.au



Dave Tang

Sales Executive

0432 523 853

8686 8388

dave.tang@areal.com.au





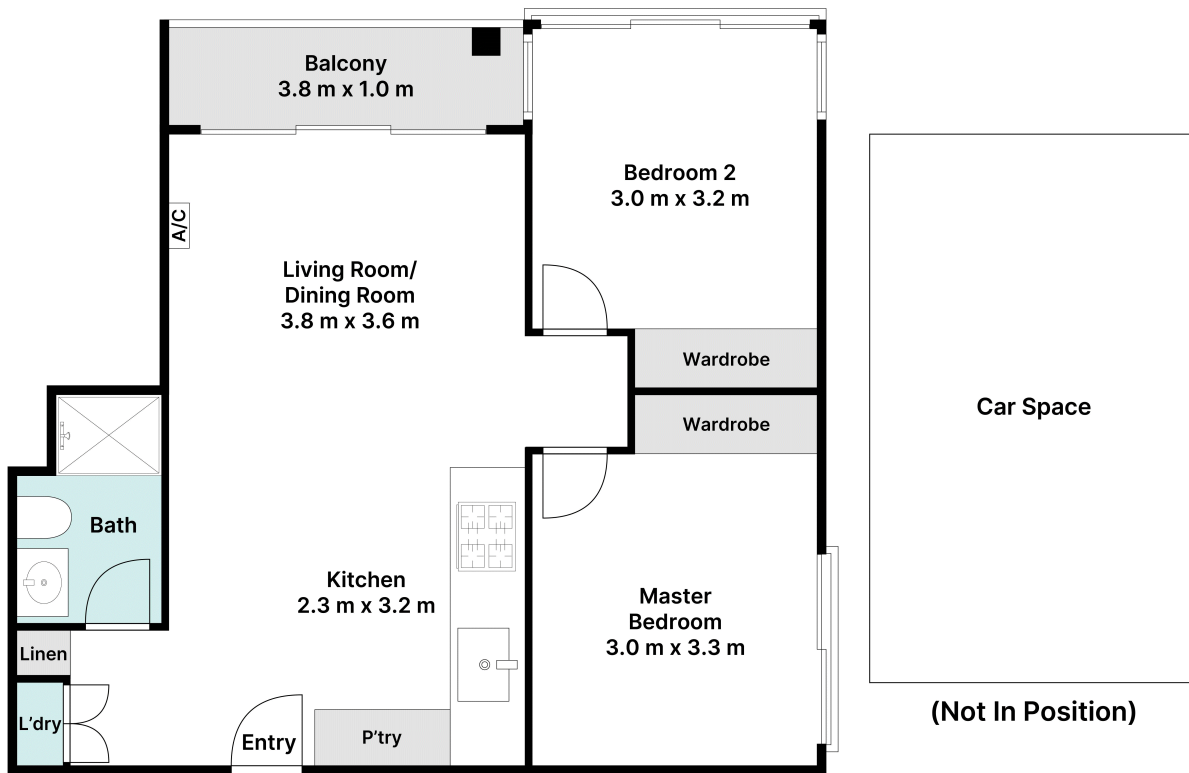

Floorplan



BOX HILL

Suite 3.4, Level 3, 990 Whitehorse Road, Box Hill. Victoria 3128 | 8686 8388

HAWTHORN EAST

33 Camberwell Road, Hawthorn. Victoria 3123 | 9818 8991

MELBOURNE CBD

Level 7, 99 Queen Street, Melbourne. VIC 3000 | 9818 8991

NORTH

Suites 4 & 5, Level 1, 494 High Street, Lalor. VIC 3075 | 03 9436 0888

POINT COOK

Entrance C4, Level 1, 2 Main Street, Point Cook. VIC 3030 | 8686 8338

SOUTH MORANG

29 Gorge Road, South Morang. VIC 3752 | 8804 5888

info@areal.com.au

areal.com.au