

Delightful Living Awaits



For Sale

1 Mujeres Walk, Epping VIC 3076

 3  2

\$600,000

For Sale

1 Mujeres Walk, Epping VIC 3076

 3  2

Delightful Living Awaits

Welcome to delightful living at 1 Mujeres Walk, Epping! This beautiful north-facing three-bedroom townhouse offers a blend of modern comfort and convenience, making it an ideal choice for both investors and first-time buyers. With two well-designed bathrooms and dual parking, this home perfectly caters to today's practical lifestyle.

Enjoy the added benefit of a lovely park right outside your door, providing a perfect space for relaxation and recreation, while the vibrant Lyndarum Shopping Centre is just a short walk away, ensuring all your shopping and dining needs are easily met. Additionally, you're conveniently located a short drive from the lively Pacific Epping Shopping Centre and the Northern Hospital, making it ideal for busy professionals and families on the go. Excellent primary and secondary schools are also just around the corner.

Set in a tranquil neighbourhood, this townhouse provides a serene retreat without compromising on proximity to essential services and major tr...



Justin Sciola

Sales Director | Auctioneer - AReal Property South Morang

0423 916 416

03 8804 5888

justin.sciola@areal.com.au







firstnational
REAL ESTATE

A/REAL

LEGEND

- 1. Courtyard | 2. Porch
- 3. Driveway

SPARTA LINK
7.11m



:: FLOOR PLAN
First Floor



:: FLOOR PLAN
Ground Floor

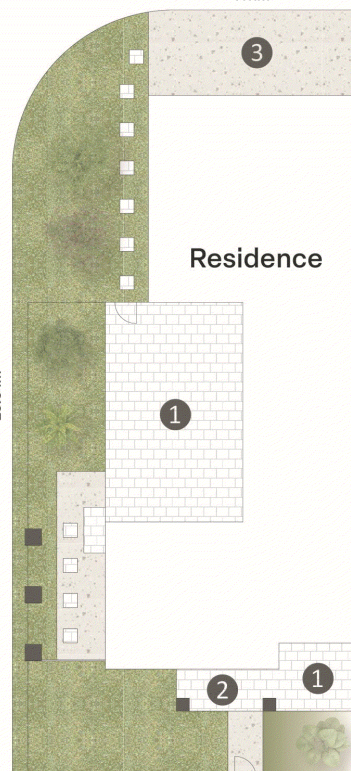

:: SITE PLAN

firstnational
REAL ESTATE

A/REAL

- 192m²
- 3 Bed
- 2 Bath
- 2 Car

Please note: This floor plan has been produced for marketing purposes and should be used as a guide only. All measurements are approximate and any person using this information should rely on their own enquiries.

BOX HILL

Suite 3.4, Level 3, 990 Whitehorse Road, Box Hill. Victoria 3128 | 8686 8388

HAWTHORN EAST

33 Camberwell Road, Hawthorn. Victoria 3123 | 9818 8991

MELBOURNE CBD

Level 7, 99 Queen Street, Melbourne. VIC 3000 | 9818 8991

NORTH

Suites 4 & 5 High Street, Lalor. VIC 3075 | 03 9436 0888

POINT COOK

Entrance C4, Level 1, 2 Main Street, Point Cook. VIC 3030 | 8686 8338

SOUTH MORANG

29 Gorge Road, South Morang. VIC 3752 | 8804 5888

info@areal.com.au