

Spacious Family Living in the Heart of Diamond Creek



For Lease

4 Siyan Rise, Diamond Creek VIC 3089

 4  2

\$920.00 Per Week

For Lease

4 Siyan Rise, Diamond Creek VIC 3089

 4  2

Spacious Family Living in the Heart of Diamond Creek

Welcome to 4 Siyan Rise, Diamond Creek, a beautifully designed family home offering comfort, space, and practicality in a quiet and highly sought-after location. With multiple living areas, generous accommodation, and fantastic indoor-outdoor flow, this home is perfectly suited for families seeking both convenience and lifestyle.

Inside, the home features four well-proportioned bedrooms, including a spacious master suite complete with walk-in robe and private ensuite. The remaining bedrooms are serviced by a central bathroom and are thoughtfully positioned to provide privacy and flexibility for the whole family.

The heart of the home is the expansive open-plan kitchen, meals, and family area, designed for easy everyday living and entertaining. The kitchen offers ample bench space, excellent storage, and overlooks the living zones, while a separate lounge at the front of the property provides an additional retreat, formal living space, or home office option.

Step outside to enjoy...



Demi Georga

Business Development Director - South Morang Office

0402 605 588

03 8804 5888

demi.georga@areal.com.au

A/REAL



A/REAL



A/REAL



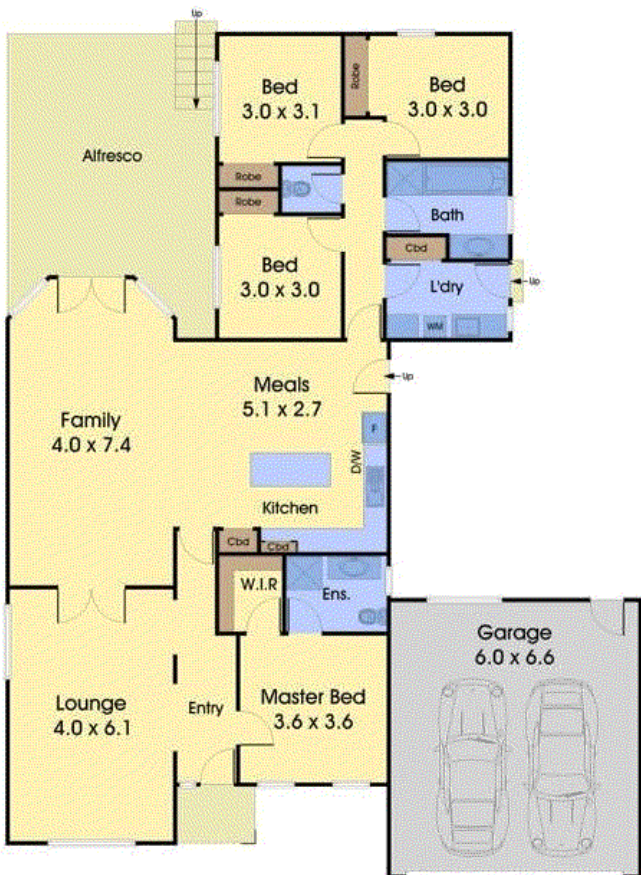

FLOOR PLAN



NOT IN PLACE



SITE PLAN

BOX HILL

Suite 3.4, Level 3, 990 Whitehorse Road, Box Hill. Victoria 3128 | 8686 8388

HAWTHORN EAST

33 Camberwell Road, Hawthorn. Victoria 3123 | 9818 8991

MELBOURNE CBD

Level 7, 99 Queen Street, Melbourne. VIC 3000 | 9818 8991

NORTH

Suites 4 & 5, Level 1, 494 High Street, Lalor. VIC 3075 | 03 9436 0888

POINT COOK

Entrance C4, Level 1, 2 Main Street, Point Cook. VIC 3030 | 8686 8338

SOUTH MORANG

29 Gorge Road, South Morang. VIC 3752 | 8804 5888

info@areal.com.au