

## Exquisite Elegance



## For Sale

13 Chocolate Lilly Street, Epping VIC 3076

 3  2  222sqm

\$651,000

## For Sale

13 Chocolate Lilly Street, Epping VIC 3076



3



2



222sqm

### Exquisite Elegance

Welcome to 13 Chocolate Lilly Street, Epping, a stunning townhouse nestled in the prestigious Lyndarum Estate. This exquisite three-bedroom home radiates elegance and comfort, tailored specifically for first home buyers, savvy investors, and those seeking to downsize without compromise. As you step inside, the home opens into a light-infused family space, meticulously maintained and boasting multiple living areas for relaxation and entertaining. The heart of this residence is the sophisticated kitchen, equipped with stainless steel appliances, including a dishwasher, that seamlessly connects to the inviting family zone and extends out to a charming undercover entertainment area with a low-maintenance garden. Ascend the stylish staircase to discover a versatile rumpus retreat, a sumptuous master suite with a private ensuite, two additional bedrooms adorned with a sparkling family bathroom, and a balcony offering serene views of the adjacent reserve. Location is paramount, and this home is...



### Justin Sciola

Sales Director | Auctioneer - AReal Property South Morang

0423 916 416

03 8804 5888

[justin.sciola@areal.com.au](mailto:justin.sciola@areal.com.au)







firstnational REAL ESTATE A/REAL

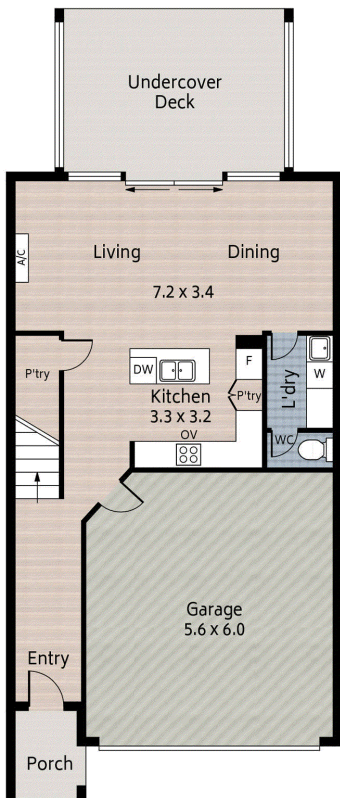

//FLOOR PLAN/Ground Floor

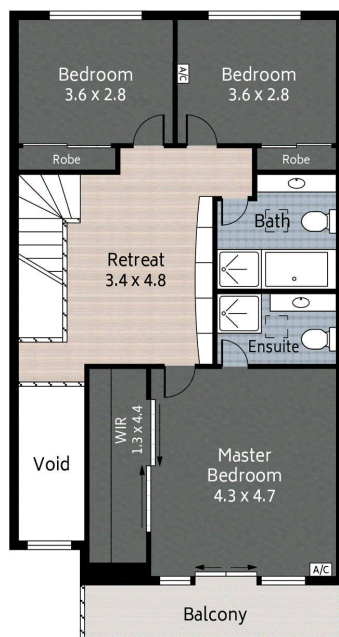

//FLOOR PLAN/First Floor

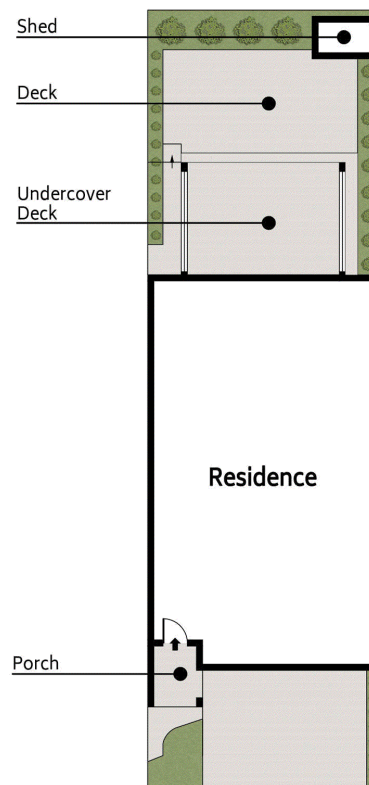

//SITE PLAN

firstnational REAL ESTATE

## A/REAL

- 221 m<sup>2</sup>
- 3 Bed
- 2 Bath
- 2 Car

Please note: This floor plan has been produced for marketing purposes and should be used as a guide only. All measurements are approximate and any person using this information should rely on their own enquiries.

Produced by MAISONSNAP.COM.AU

## BOX HILL

Suite 3.4, Level 3, 990 Whitehorse Road, Box Hill. Victoria 3128 | 8686 8388

## HAWTHORN EAST

33 Camberwell Road, Hawthorn. Victoria 3123 | 9818 8991

## MELBOURNE CBD

Level 7, 99 Queen Street, Melbourne. VIC 3000 | 9818 8991

## NORTH

Suites 4 & 5 High Street, Lalor. VIC 3075 | 03 9436 0888

## POINT COOK

Entrance C4, Level 1, 2 Main Street, Point Cook. VIC 3030 | 8686 8338

## SOUTH MORANG

29 Gorge Road, South Morang. VIC 3752 | 8804 5888

[info@areal.com.au](mailto:info@areal.com.au)