

Epitome of Modern Living



For Sale

2 Soho Crescent, Wollert VIC 3750

 3  2

Awaiting Price Guide

For Sale

2 Soho Crescent, Wollert VIC 3750

 3  2

Epitome of Modern Living

Discover the epitome of modern living in this stunning three-bedroom townhouse, a true gem that caters to both discerning first home buyers and astute investors alike. Designed with meticulous attention to detail, each space radiates contemporary elegance, from the sleek stone bench tops to the gleaming stainless appliances that promise to delight any culinary enthusiast. Two generous living areas provide ample space for relaxation and entertainment, ensuring that whether you're hosting a lively gathering or enjoying a quiet evening, your home adapts effortlessly to your lifestyle. The covered outdoor area invites you to extend your living space into the open air, perfect for alfresco dining or simply unwinding in the tranquility of your low maintenance backyard. Each of the three beautifully appointed bedrooms offers a haven of comfort, with the master boasting an en-suite bathroom for added privacy and convenience. The additional bathroom serves the remaining rooms, ensuring that both...



Justin Sciola

Sales Director | Auctioneer - AReal Property South Morang

0423 916 416

03 8804 5888

justin.sciola@areal.com.au







firstnational REAL ESTATE | A/REAL

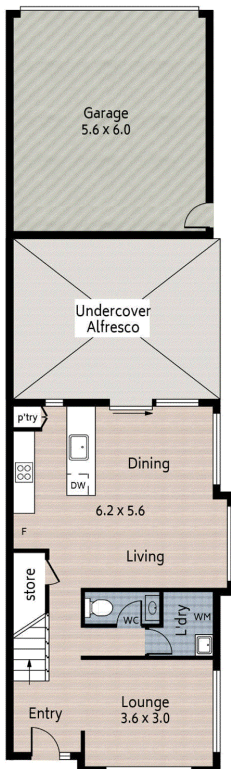

//FLOOR PLAN/Ground Floor

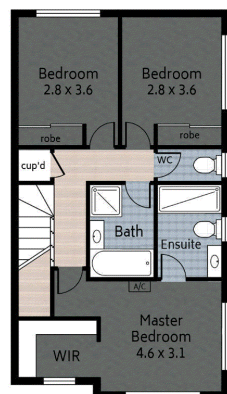

//FLOOR PLAN/First Floor

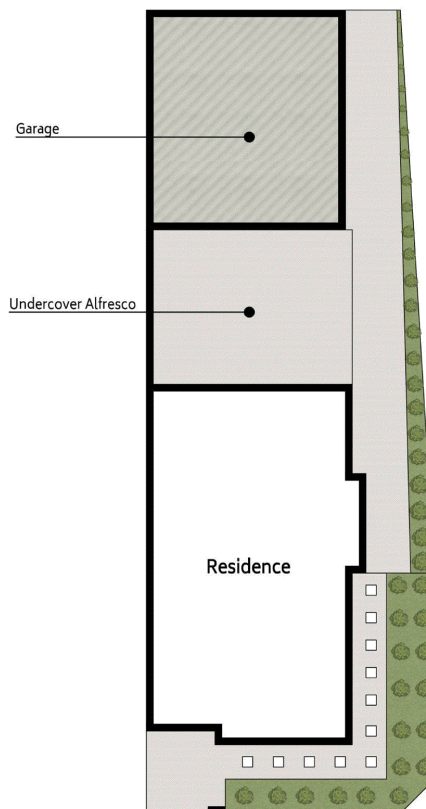

//SITE PLAN

firstnational REAL ESTATE

A/REAL

- 218 m²
- 3 Bed
- 2 Bath
- 2 Car

Please note: This floor plan has been produced for marketing purposes and should be used as a guide only. All measurements are approximate and any person using this information should rely on their own enquiries.
Produced by MAISONSNAP.COM.AU

BOX HILL

Suite 3.4, Level 3, 990 Whitehorse Road, Box Hill. Victoria 3128 | 8686 8388

HAWTHORN EAST

33 Camberwell Road, Hawthorn. Victoria 3123 | 9818 8991

MELBOURNE CBD

Level 7, 99 Queen Street, Melbourne. VIC 3000 | 9818 8991

NORTH

Suites 4 & 5 High Street, Lalor. VIC 3075 | 03 9436 0888

POINT COOK

Entrance C4, Level 1, 2 Main Street, Point Cook. VIC 3030 | 8686 8338

SOUTH MORANG

29 Gorge Road, South Morang. VIC 3752 | 8804 5888

info@areal.com.au