

Elevated Corner Living with City Skyline & Park Views



For Sale

802/45 Dudley Street, West Melbourne VIC 3003



2



2



85sqm

\$565,000-\$595,000

For Sale

802/45 Dudley Street, West Melbourne VIC 3003

 2  2  85sqm

Elevated Corner Living with City Skyline & Park Views

Positioned in a prized corner setting within the tightly held Flagstaff Hill complex, this beautifully maintained two-bedroom, two-bathroom residence delivers an exceptional standard of city-edge living, defined by natural light, quality finishes and sweeping outlooks.

Set on Level 8, the apartment enjoys an abundance of light through expansive glazing, enhancing the open-plan living and dining domain. The space flows seamlessly to a private balcony—an ideal retreat to unwind or entertain while taking in views across the Melbourne skyline and the greenery of Flagstaff Gardens.

The sophisticated kitchen is appointed with stone benchtops, mirrored splashback, premium appliances and streamlined cabinetry, combining refined aesthetics with everyday functionality.

Accommodation is thoughtfully designed, with the oversized master bedroom featuring built-in robes and a sleek ensuite, while the second bedroom is well-proportioned and serviced by a stylish central bathroom, both finished wi...



Kay Lim

Sales Executive, Licensed Estate Agent

0416 260 421

03 8686 8388

kay.lim@areal.com.au



Aaron Tan

Sales Executive

0421 247 332

03 8686 8388

aaron.tan@areal.com.au





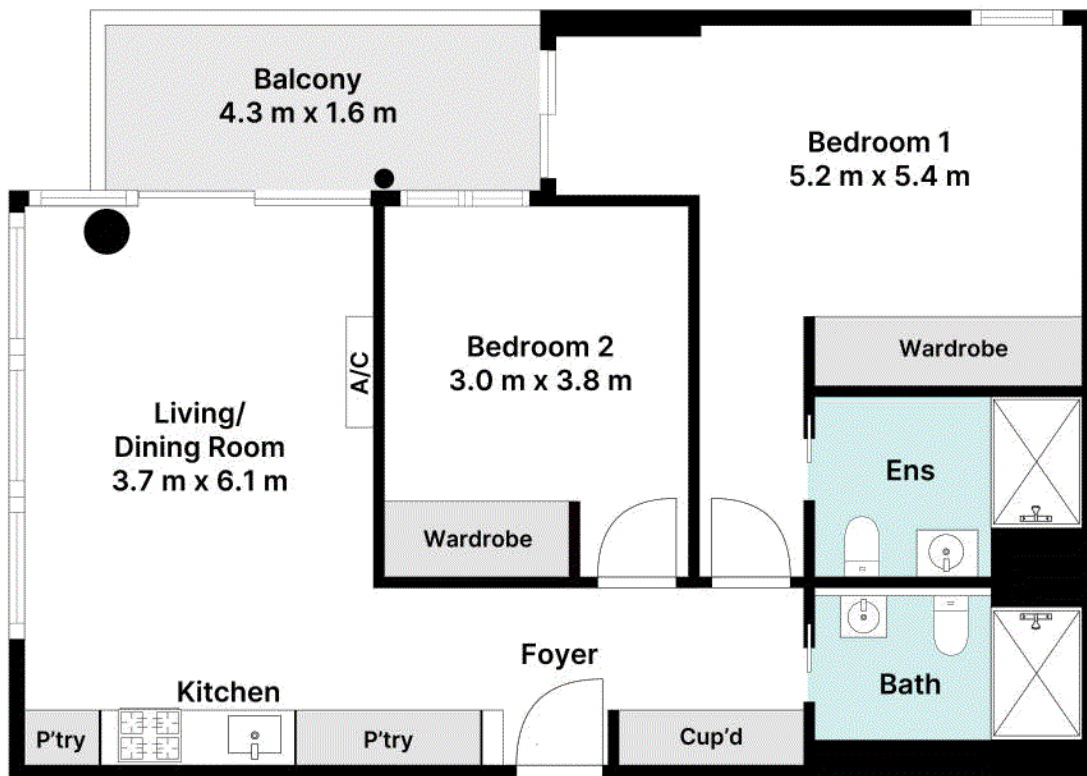

Floor Plan

BOX HILL

Suite 3.4, Level 3, 990 Whitehorse Road, Box Hill. Victoria 3128 | 8686 8388

HAWTHORN EAST

33 Camberwell Road, Hawthorn. Victoria 3123 | 9818 8991

MELBOURNE CBD

Level 7, 99 Queen Street, Melbourne. VIC 3000 | 9818 8991

NORTH

Suites 4 & 5 High Street, Lalor. VIC 3075 | 03 9436 0888

POINT COOK

Entrance C4, Level 1, 2 Main Street, Point Cook. VIC 3030 | 8686 8338

SOUTH MORANG

29 Gorge Road, South Morang. VIC 3752 | 8804 5888

info@areal.com.au