

## Charming 2-Bedroom Townhouse in Wollert - Perfect Blend of Comfort and Convenience



### For Lease

8/62 Anzac Drive, Wollert VIC 3750

 2  1

\$470 Per Week

## For Lease

8/62 Anzac Drive, Wollert VIC 3750



### Charming 2-Bedroom Townhouse in Wollert - Perfect Blend of Comfort and Convenience

This charming 2-bedroom, 1-bathroom townhouse in Wollert offers a perfect blend of comfort and convenience. Nestled in a quiet and peaceful neighborhood, this property boasts a homely and cozy ambiance that is sure to make you feel right at home.

As you step inside, you are greeted by a bright and airy living space that is perfect for relaxing or entertaining guests. The kitchen is equipped with all the necessary appliances and ample storage space, making meal preparation a breeze.

The two well-appointed bedrooms offer plenty of natural light and storage space, providing a peaceful retreat at the end of the day. The bathroom features modern fixtures and a relaxing bathtub, perfect for unwinding after a long day.

Outside, the property features a private courtyard, ideal for enjoying your morning coffee or hosting a barbecue with friends and family. With two car spaces, parking will never be an issue.

Conveniently located near shops, schools, parks, and public transport, this townho...



**Benita Evans**

Relationship Manager

03 8804 5888

[benita.evans@areal.com.au](mailto:benita.evans@areal.com.au)



**Ayda Badri**

Relationship Manager

03 8804 5888

[ayda.badri@areal.com.au](mailto:ayda.badri@areal.com.au)



A/REAL





A/REAL

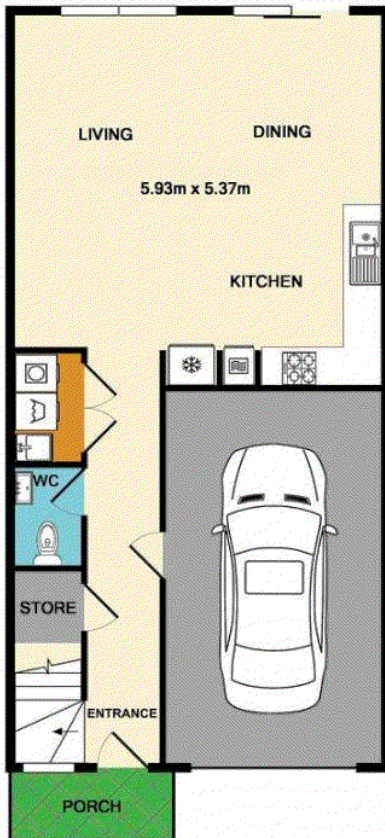

GROUND FLOOR

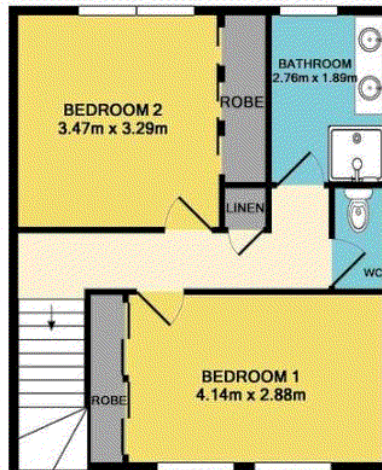

1ST FLOOR



NO. 8/62 ANZAC AVENUE WOLLERT  
 Measurements are approximate. Not to Scale. For illustrative purposes only.

## BOX HILL

Suite 3.4, Level 3, 990 Whitehorse Road, Box Hill. Victoria 3128 | 8686 8388

## HAWTHORN EAST

33 Camberwell Road, Hawthorn. Victoria 3123 | 9818 8991

## MELBOURNE CBD

Level 7, 99 Queen Street, Melbourne. VIC 3000 | 9818 8991

## NORTH

Suites 4 & 5 High Street, Lalor. VIC 3075 | 03 9436 0888

## POINT COOK

Entrance C4, Level 1, 2 Main Street, Point Cook. VIC 3030 | 8686 8338

## SOUTH MORANG

29 Gorge Road, South Morang. VIC 3752 | 8804 5888

[info@areal.com.au](mailto:info@areal.com.au)