

## Invest In Prized Student Accommodation In Central Box Hill



### For Sale

402/8 Bruce Street, Box Hill VIC 3128

 1  1

\$135,000

## For Sale

402/8 Bruce Street, Box Hill VIC 3128



### Invest In Prized Student Accommodation In Central Box Hill

\* Appointments only

Positioned gracefully between the expansive greenery of Box Hill Gardens and the vibrant pulse of Box Hill Central Shopping Centre, this impeccably maintained studio apartment presents an enticing opportunity for astute investors seeking prime student accommodation.

Flooded with natural light, immaculate interior spaces reveal an open-plan living/dining area with a well-appointed kitchen, bedroom, bathroom, East-facing balcony, secure intercom entry and communal laundry.

Take advantage of the enduring market appeal of this location, surrounded by diverse cafes, restaurants and ample shopping opportunities. Additionally, benefit from easy proximity to Box Hill train station for city-bound trains, trams running along Whitehorse Rd and buses connecting to Westfield Doncaster.

Disclaimer: We have in preparing the content used our best endeavours to ensure that the information contained is true and accurate, but accept no responsibility and disclaim all liability in...



#### Andy Yuan

Senior Sales Executive, Licensed Estate Agent, Auctioneer

0406 217 388

03 8686 8388

[andy.yuan@areal.com.au](mailto:andy.yuan@areal.com.au)



#### Dave Tang

Sales Executive

0432 523 853

03 8686 8388

[dave.tang@areal.com.au](mailto:dave.tang@areal.com.au)



A/REAL



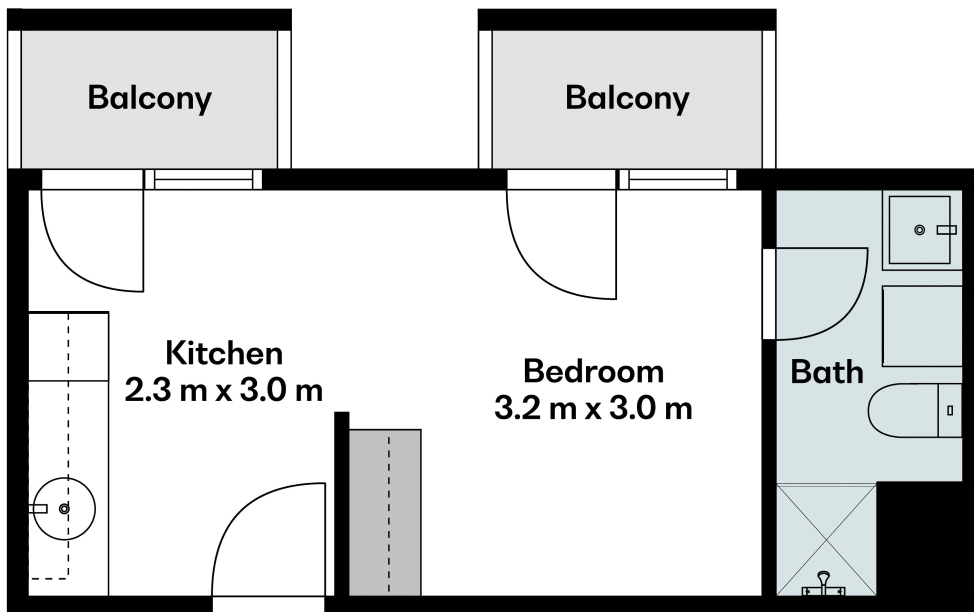

Total area: 25 m<sup>2</sup> (approx.)



#### BOX HILL

Suite 3.4, Level 3, 990 Whitehorse Road, Box Hill. Victoria 3128 | 8686 8388

#### HAWTHORN EAST

33 Camberwell Road, Hawthorn. Victoria 3123 | 9818 8991

#### MELBOURNE CBD

Level 7, 99 Queen Street, Melbourne. VIC 3000 | 9818 8991

#### NORTH

Suites 4 & 5 High Street, Lalor. VIC 3075 | 03 9436 0888

#### POINT COOK

Entrance C4, Level 1, 2 Main Street, Point Cook. VIC 3030 | 8686 8338

#### SOUTH MORANG

29 Gorge Road, South Morang. VIC 3752 | 8804 5888

[info@areal.com.au](mailto:info@areal.com.au)

[areal.com.au](http://areal.com.au)