

School Zone' At Your Fingertips



For Lease

3 Chester Street, Glen Waverley VIC 3150

 3  2

\$690 per Week

For Lease

3 Chester Street, Glen Waverley VIC 3150



School Zone' At Your Fingertips

Open for Inspections Schedule: Every Saturday and Private Inspection upon request (please register and get the confirmation booking)

****ARRANGE AN INSPECTION TIME ONLINE - DETAILS BELOW****

This double-story residence showcases an exceptional interplay of light and space with the comfort of low-maintenance living. Families will love walking distance to The Glen shopping center, Kingsway eateries and entertaining district, Novotel, and close to a selection of fine schools, such as Glen Waverley Secondary College, Glen Waverley Primary School, etc.

- Three spacious bedrooms all with built-in robes
- Spacious living area
- Modern kitchen with gas cooking, oven, dishwasher, and ample storage space
- Separate dining/meals area
- Central bathroom situated upstairs with separate shower and separate bathtub
- Separate laundry
- Ducted heating
- Low maintenance living
- Double garage

* FURNISHED/UNFURNISHED: This property is NOT furnished, the furnishings included in this listing are purely f...



Steven Wang

Senior Relationship Manager, Licensed Estate Agent

03 9818 8991

steven.wang@areal.com.au





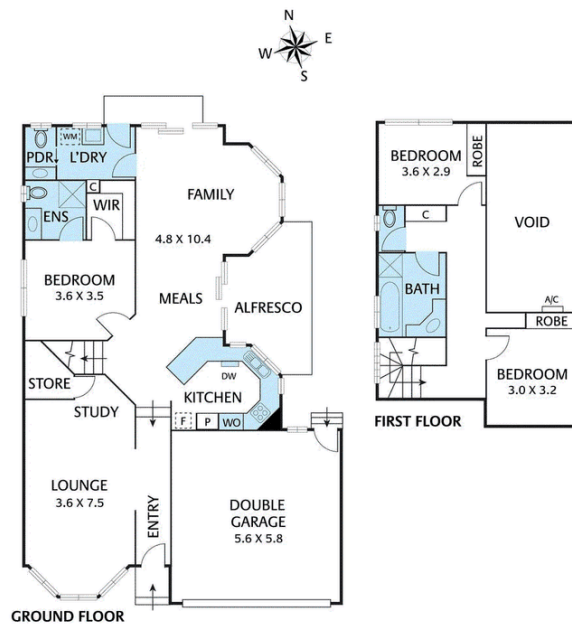

BOX HILL

Suite 3.4, Level 3, 990 Whitehorse Road, Box Hill. Victoria 3128 | 8686 8388

HAWTHORN EAST

33 Camberwell Road, Hawthorn. Victoria 3123 | 9818 8991

MELBOURNE CBD

Level 7, 99 Queen Street, Melbourne. VIC 3000 | 9818 8991

NORTH

Suites 4 & 5 High Street, Lalor. VIC 3075 | 03 9436 0888

POINT COOK

Entrance C4, Level 1, 2 Main Street, Point Cook. VIC 3030 | 8686 8338

SOUTH MORANG

29 Gorge Road, South Morang. VIC 3752 | 8804 5888

info@areal.com.au